

ICL-300

4' Inner Canopy LED Bar with Built-in 120 Watt Driver

The ThinkGrow Model One LED System 4ft Inner Canopy LED Bar with built-in 120 Watt Driver, will revolutionize high-density indoor growing. When applying light to plants only from above the plants, leaves and sections of the plant below the top “canopy” of the plant suffer from low light levels. That is the exact problem the ICL-300 is designed to fix. The ICL-300 emits light in a 300 degree pattern so that when positioned below the canopy, the sections of the plant under the canopy can also get the light they need to produce higher quality and yields. By applying some light to the middle of the plant structure, the user can eliminate lower quality flower formation and replace it with healthy flowers. The modular design of the ICL-300 allows them to be used in all installations regardless of the shape or size of the growing area.



Specifications

ICL-300

PPF

PPF >314 umol/s

Input Power

Input Power 120W

Voltage:

Voltage 100-277VAC, 50/60Hz

Lifetime

Lifetime L90:> 54,000 hrs

IP Water Resistance

IP IP56

Warranty

Warranty 5 Years Standard Warranty

Working Environments

Temperature 32-104°F (0-40°C)

Humidity 5~95%RH

Dimensions/Weight

Size 46.21"(L) x 3.60"(W) x 2.64"(H)

Gross Weight 6.17lbs /2.8kg

Installation Guide

ICL-300

ICL-300 Installation Guide

Option 1 - Hang the LED from Above

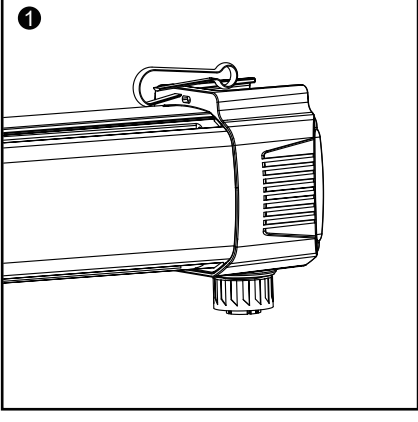

Step 1: Carefully insert the hooks into the two mounting holes located on the opposing sides of the light bar. Ensure that the hooks are firmly secured in place, providing a secure connection for the subsequent steps.

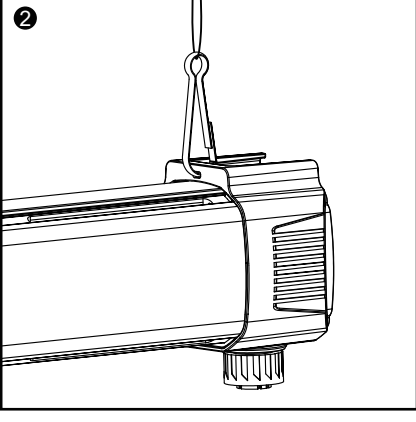

Step 2: The ICL-300 can be suspended from the ceiling or from above using an appropriate length of rope, wire rope or cable. Select a secure mounting point using appropriate hanging hardware. Exercise caution during this process to ensure that the ICL-300 is correctly positioned and securely fastened.

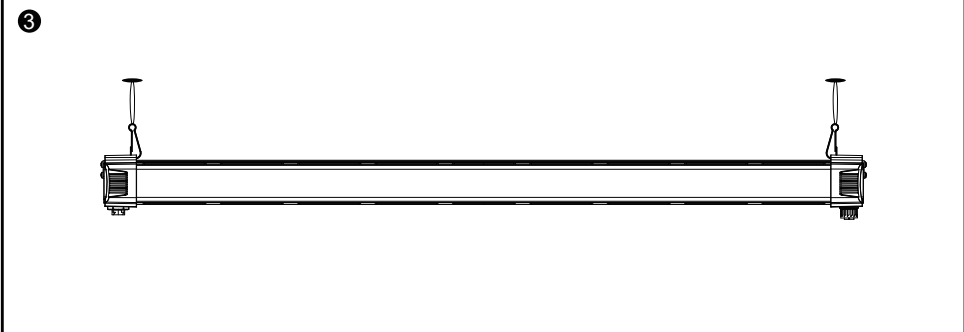

Step 3: Once the ICL-300 has been installed and is hanging freely, test the support mechanism to ensure it is capable of supporting the full weight of the ICL-300.

Option 2 - Use user-provided tubing (¾ - 1” OD tubing)

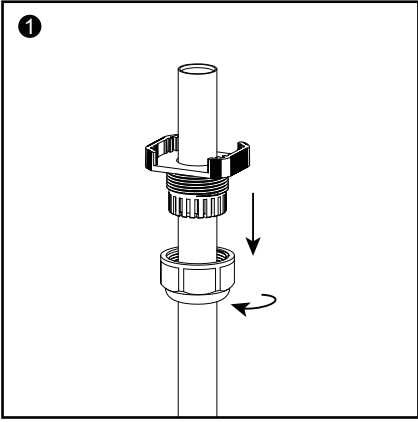

Step 1: Utilize the two Collar Mounts which are provided with each ICL-300 to securely fasten the ICL-300 onto two PVC or metal pipes or conduits with a diameter ranging from ¾” to 1” or 18mm to 25mm. Begin by loosening the screw cap on the adjustment knob, allowing the tubes to pass through the screw cap. Next you can position both ends of the ICL-300 to the desired orientation / height and secure it in place by tightening the screw cap.

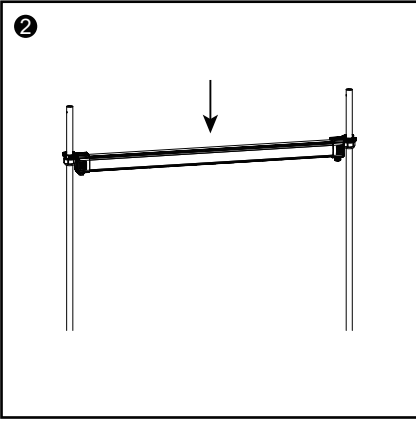

Step 2: To install the light bars, align the holes on both sides of the ICL-300 light bar with the vertical tubes. Align the mounting bracket on the vertical tube, with the bracket on the ICL-300 to ensure a secure connection between the light bar and the vertical tubes. It is essential to conduct a thorough inspection to ensure proper alignment and secure installation before proceeding.

Option 3 - ThinkGrow TSD-1 vertical LED stand

ThinkGrow offers a 3rd convenient solution, the ThinkGrow LED Stand for ICL-300 (Single Unit), known as TSD-1. The TSD-1 is an optional accessory that allows a single ICL-300 to be installed within the growing area. Two TSD-1 stands are required to install a single ICL-300. Add one more TSD-1 to add each additional ICL-300. The TSD-1 stand comes with the support bracket, and two sections of aluminum tubing. To install the stand, follow these steps:

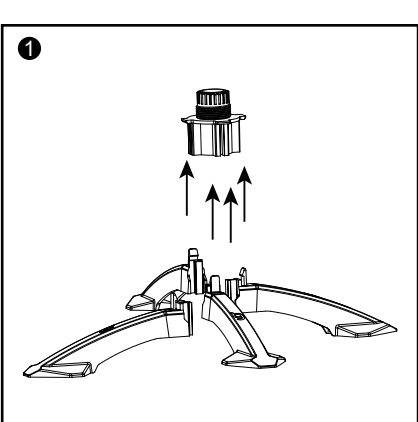

Step 1: Begin by inserting each of the 4 molded legs into the central mounting bracket. Ensure that all 4 legs are securely installed and have “snapped” into place.

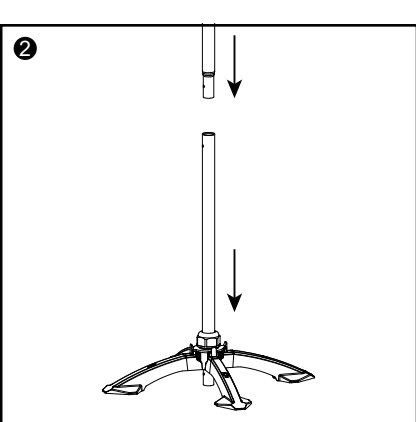

Step 2: Loosen the screw cap to create an opening, allowing the aluminum tube to pass through the screw cap at the top of the central mounting bracket. Make necessary adjustments and firmly tighten the screw cap. Users have the option to utilize one or two sections of aluminum tubes.

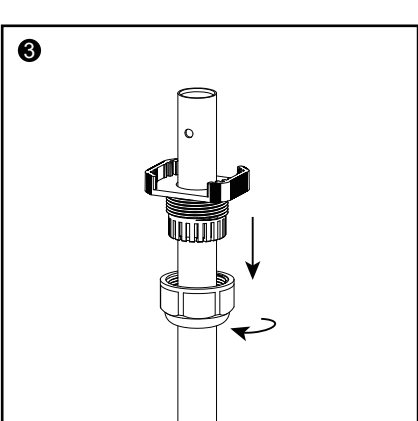

Step 3: Utilize the two Collar Mounts which are provided with each ICL-300 to securely fasten the ICL-300 onto the aluminum tubing. Begin by loosening the screw cap on the adjustment knob, allowing the tubes to pass through the screw cap. Next you can position both ends of the ICL-300 to the desired orientation / height and secure it in place by tightening the screw cap.

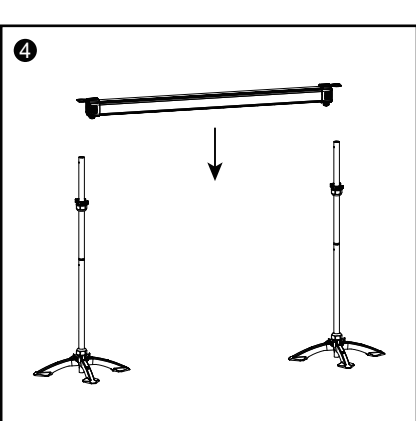

Step 4: To install the light bars, align the holes on both sides of the ICL-300 light bar with the aluminum tubes. Align the mounting bracket on the tube, with the bracket on the ICL-300 to ensure a secure connection between the light bar and the tubes. It is essential to conduct a thorough inspection to ensure proper alignment and secure installation before proceeding.

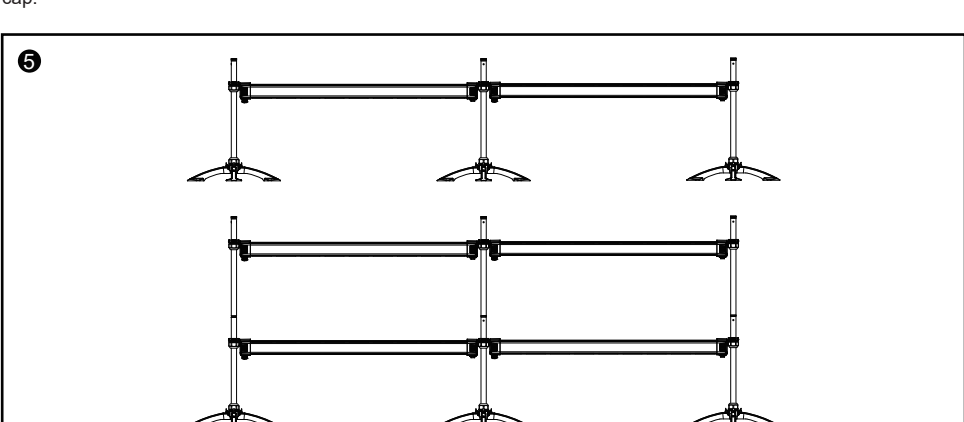

Step 5: To validate the stability of the installation, double-check that all of the screw-nuts have been tightened and all of the ICL-300 brackets are aligned and joined to the TSD-1 correctly. Then gently push and shake the stand. If the stand remains steady without any notable movement, the installation can be considered successful and complete. Make adjustments or tighten hardware if the assembly seems loose or unstable.

*The TSD-1 ThinkGrow LED Stand for ICL-300 (Single Unit) is not included in ICL-300 package contents. It is an optional accessory.

